

Overview

The **NeoWave TxTHM96** series temperature and humidity sensor uses a high-precision temperature and humidity sensor with high accuracy, fast response, and excellent long-term stability. The back of the device has four strong magnets, allowing it to be directly attached to cabinets or wall-mounted, significantly improving installation efficiency. It can display temperature, humidity, and address.

Features

- Dual RJ45 interfaces with daisy-chain wiring.
- Quick address/ baud rate setup via DIP switches.
- Compact housing displaying temp, humidity, and address.
- Magnetic/hanging design for easy installation.

Dimensions

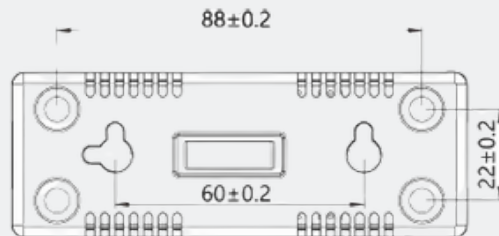
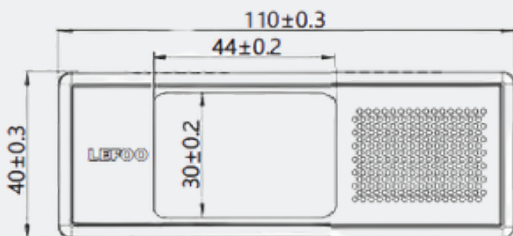

TxTHM98

Magnetic Temperature & Humidity Sensor



Applications

- Communication rooms monitoring.
- Warehouse storage conditions.
- Building climate control.
- Library material preservation.
- Data center environmental monitoring.
- Greenhouse regulation.
- Museum artifact protection.
- Laboratory environmental stability.

Specifications

Magnetic Temperature & Humidity Sensor

Relative humidity

Sensor	Digital
Range	0%~100%RH
Output	RS485/Modbus
Accuracy	±3%@ 20°C & 60%RH

Temperature

Sensor	Digital type
Output	RS485/Modbus
Accuracy	±0.3°C@20°C (see temperature accuracy curve)
Power Supply	9-26VDC
Shell Material	ABS housing
Working Environment	-20~60°C, 5%-95%RH (non-condensing)
Protection Level	IP30
Display	Optional LCD display with unit display

Temperature Accuracy Curve

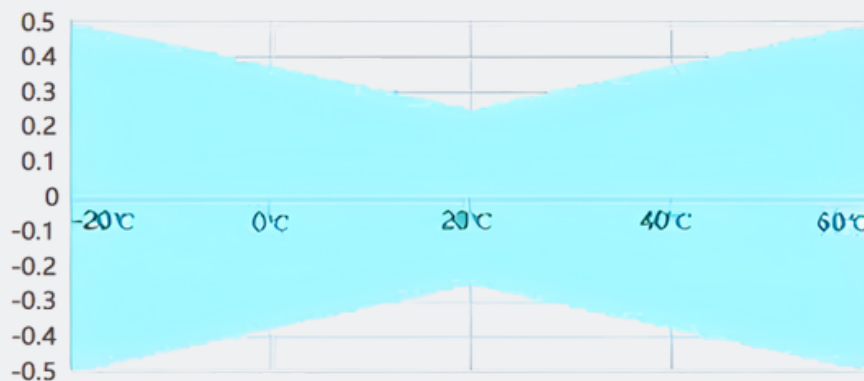

Wiring Instructions

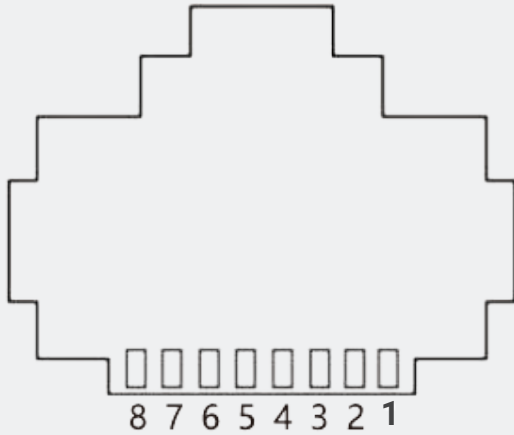

- | | |
|---------------------|---------------------|
| 1.RS485(A) | 5.RS485(B) |
| 2.RS485(B) | 6.V- Power Negative |
| 3.V+ Power Positive | 7.Open |
| 4.RS485(A) | 8.V- Power Negative |

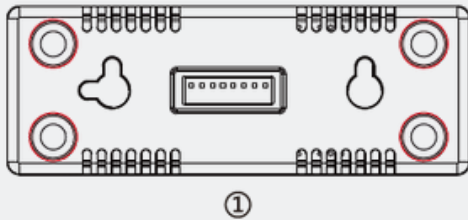

The device has a magnetic back design and can be directly attached to cabinets (as shown in ①)

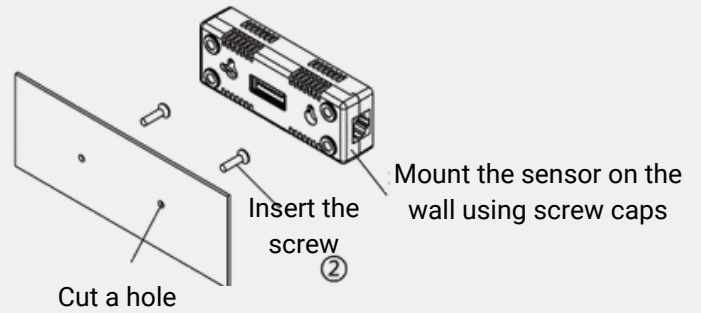

Wall-mounted installation (as shown in ②)