



### Overview:

The TxTH91-XP Sensors specialized in monitoring and controlling temperature and humidity levels within indoor environments. With a contemporary design, they can be easily mounted on walls or standard wall boxes. Optional color displays with durable glass fronts are available, and they support communication via Modbus or BACnet protocols.

### Feature:

- Temperature and humidity room sensors for monitoring
- Integration compatibility with BACnet MS/TP or Modbus RS485 RTU systems
- Optional 2.4" color LCD screen for displaying measurements
- Configuration via Device Configuration Tool Software (Windows) or iOS App (Bluetooth)
- Available in white and black options
- Customizable user display language with language packs

### Dimensions and Installation:

These devices are commonly installed on flat walls or junction boxes. The enclosure features a standard mounting box screw distance of 60/56mm.

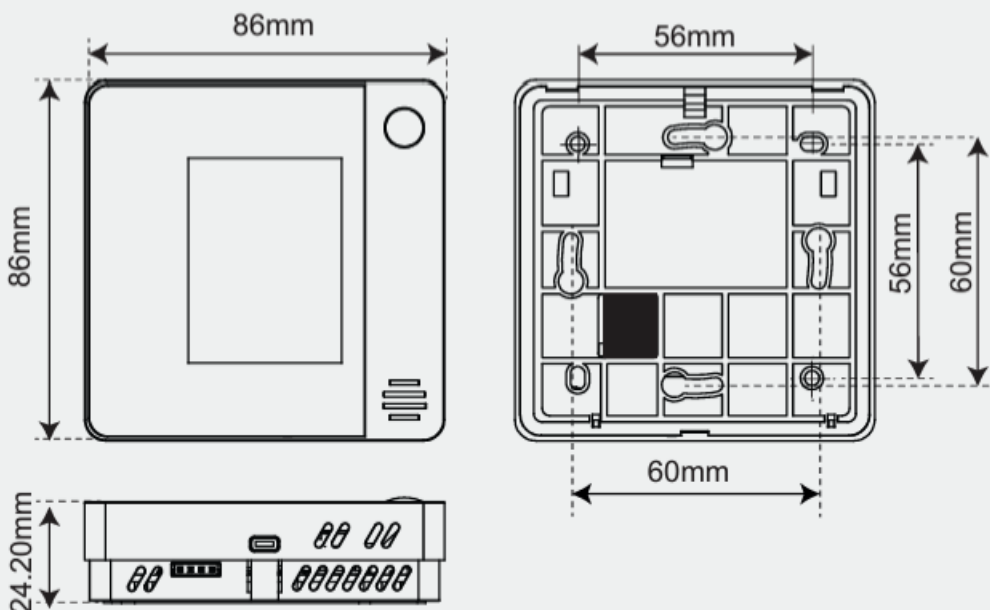

### TxTH91-XP

### Room Humidity and Temperature Sensor



### Installation Guidelines:

- Refer to the diagram below for opening the enclosure to access mounting holes and wiring terminals.
- Place sensors away from heat and cold sources, such as direct sunlight or exterior walls.
- Optimal performance is achieved when sensors are installed at a height of 150-120 cm.
- Ensure cable entries and junction boxes are sealed to prevent air flows, which can cause temperature measurement inaccuracies.
- Use the dedicated hole (black area) marked on the dimensions drawing for cable entry.
- If surface-mounted cable is needed, the top center of the enclosure has a thin wall section that can be cut.

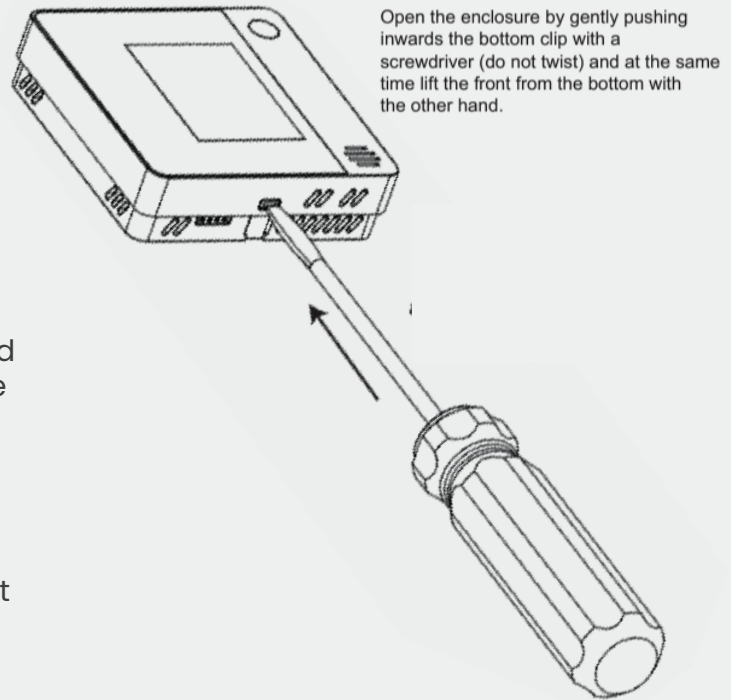

### Specifications:

#### Room Humidity and Temperature Sensor

Power supply	24Vac/dc -10%/+15%, max 80mA with display		
Measurements	Temperature	Range	0..50° (32..122°F)
		Accuracy	"±0.5°C"
	Humidity	Range	0..100%rh
		Accuracy	"±2%rh (within 20 to 80%rh)"
Communication	Physical Interface	1 x RS485 driver, recommended max 63 devices	
	Protocol	Modbus RTU or BACnet MS/TP (order relevant model)	
	Addressing	Via Software: 1..247 for Modbus, 1..127 for BACnet MS/TP	
	Settings	Baud Rate: 9600/19200/38400/57600/76800/115200 (software) Modbus Parity: None/Even/Odd, Modbus Stop Bits: 1 or 2 (Default: 9600/None/1)	
Mechanical	Wiring Terminals	Rising Cage Screw Terminals, 0.2 to 2.5mm <sup>2</sup> / 26 to 12 AWG	
	Enclosure	ABS ULV0 Plastics - White or Black	
	Mounting	Wall or Junction Box Mounting (60mm screw distance)	
	Dimensions	W86 x H86 x D24mm	
Display	LCD Option	Optional 2.4" Full Colour Display with Glass Overlay, 240 x 320px	



**Order Informations:**

Code and description		Remark
TxTH91-XP	Room Humidity and Temperature Sensor	Model
1	MOD Modbus RS485	Communication Options
2	BAC BACnet MS/TP	
1	No Interface	Interface Options
2	Colour Display	
B	<b>Black</b>	Colour Options
W	White	