



Niji

NEO WAVE[®]

Elevate Comfort, Save Energy
Neo Wave Smart Thermostats

neowave.tech

TRM-001 Fan Coil Thermostat

Product Features:



01
LCD integrated
screen display



02
Oval soft
Shape design



03
Pc Flame retardant
high
Transparency Panel

Wiring Diagram:

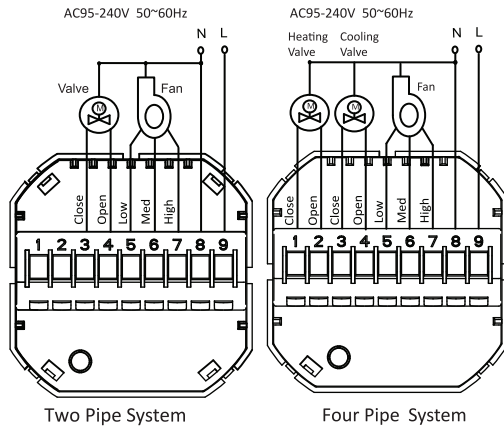

Installation Steps:

Fig1



1. Turn Off The Main Power Supply
2. Unscrew The Installation Panel By Twisting The Display Frame

Fig2



Fig3



3. Refer to the wiring diagram and Fig3, And connect the TRMK cover circuit of the product.

Fig4



4. Fix the installation panel with the 60mm european-style cassette with screws and embed it into the wall.

Fig5



5. Rotate the display section TRMK to the mounting panel.

Fig6

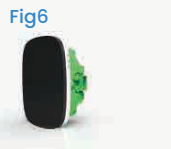

6. Installation is Completed.



Smart Home First Choice:

Simple black and white design
Understated Luxury.

Unique UI Design Interface.
All-in-one Window.
Negative Black Screen.





TRM-001

Fan Coil Thermostat series Selection table

No	Model	Power Supply		Control		Fan			Application					Additional						Color						
		220VAC	24VAC	Heat	Cool	1 Speed	3 Speed	0-1 0V	2-pipe	4-pipe	2 wired Motorized Valve	3 wired Motorized Valve	0-1 0V Motorized Valve	0-1 0V Damper	Modbus	WIFI	Zigbee	Keycard	Window	Programmable	External Sensor	Battery	White	Black	Brushed SS	Other
1	TRM-001 AL	✓	✓	✓	✓		✓			✓	✓									✓		Optional		✓		
2	TRM-001 ALN	✓	✓	✓	✓		✓			✓	✓			✓						✓				✓		
3	TRM-001 ALW	✓	✓	✓	✓		✓			✓	✓				✓					✓				✓		
4	TRM-001 ALZB	✓	✓	✓	✓		✓			✓	✓						✓			✓				✓		
5	TRM-001 EL	✓	✓	✓	✓		✓		✓	✓	✓									✓		Optional		✓		
6	TRM-001 ELN	✓	✓	✓	✓		✓		✓	✓	✓			✓						✓				✓		
7	TRM-001 ELW	✓	✓	✓	✓		✓		✓	✓	✓				✓					✓				✓		
8	TRM-001 ELZB	✓	✓	✓	✓		✓		✓	✓	✓						✓			✓				✓		
9	TRM-001 ML	✓	✓	✓	✓		✓	✓				✓								✓		Optional		✓		
10	TRM-001 MLN	✓	✓	✓	✓		✓	✓				✓		✓						✓				✓		
11	TRM-001 MLW	✓	✓	✓	✓		✓	✓				✓			✓					✓				✓		

TRM-002 Fan Coil Thermostat

Product Features:



01

LCD Integrated Screen Display.



02

Oval Soft Shape Design



03

Pc Flame retardant high Transparency Panel

Wiring Diagram:

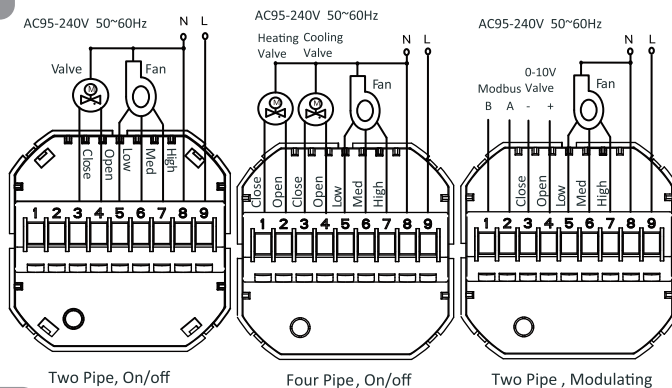

Installation Steps:

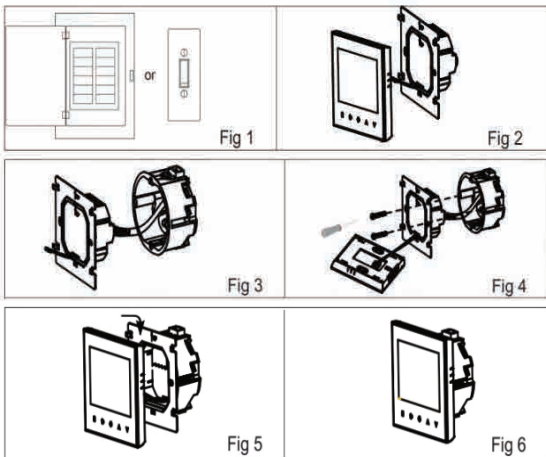

1. After correctly connecting the power supply and equipment cables to the terminals of the power supply box use a screwdriver to pass the screws through the mounting steel plate and fix them on the cassette.
2. After the power box is fixed connect the cable to the operation panel.
3. Put the operation panel against the installation steel plate and slide it down.
4. Installation is complete.



Define a new mode of intelligent temperature control

Concave and convex panel design rejects old-fashioned monotony.

Blue round switch button, Smart and extraordinary.

No. 1 In B2C Sales, Best-selling in Europe and United States.

WIFI/MODBUS Optional.





TRM-002

Fan Coil Thermostat series Selection table

No	Model	Power Supply		Control		Fan			Application					Additional							Color						
		220VAC	24VAC	Heat	Cool	1 Speed	3 Speed	0-1 0V	2-pipe	4-pipe	2 wired Motorized Valve	3 wired Motorized Valve	0-1 0V Motorized Valve	0-1 0V Damper	Modbus	WIFI	Zigbee	Keycard	Window	Programmable	External Sensor	Battery	White	Black	Black Outside	White Outside	
1	TRM-002 AL	✓	✓	✓	✓		✓		✓		✓	✓								✓		Optional	✓	✓	✓	✓	
2	TRM-002 AL N	✓	✓	✓	✓		✓		✓		✓	✓		✓										✓	✓	✓	✓
3	TRM-002 AL K	✓	✓	✓	✓		✓		✓		✓	✓					✓			✓		Optional	✓	✓	✓	✓	
4	TRM-002 AL NE	✓	✓	✓	✓		✓		✓		✓	✓		✓						✓			✓	✓	✓	✓	
5	TRM-002 AL W	✓	✓	✓	✓		✓		✓		✓	✓			✓					✓			✓	✓	✓	✓	
6	TRM-002 AL ZB	✓	✓	✓	✓		✓		✓		✓	✓				✓				✓			✓	✓	✓	✓	
7	TRM-002 EL	✓	✓	✓	✓		✓			✓	✓	✓								✓		Optional	✓	✓	✓	✓	
8	TRM-002 EL N	✓	✓	✓	✓		✓			✓	✓	✓		✓									✓	✓	✓	✓	
9	TRM-002 EL NK	✓	✓	✓	✓		✓			✓	✓	✓		✓			✓						✓	✓	✓	✓	
10	TRM-002 EL W	✓	✓	✓	✓		✓			✓	✓	✓			✓					✓			✓	✓	✓	✓	
11	TRM-002 EL ZB	✓	✓	✓	✓		✓			✓	✓	✓				✓				✓			✓	✓	✓	✓	
12	TRM-002 EL NE	✓	✓	✓	✓		✓			✓	✓	✓		✓						✓			✓	✓	✓	✓	
13	TRM-002 M L	✓	✓	✓	✓		✓		✓				✓							✓		Optional	✓	✓	✓	✓	
14	TRM-002 M L N	✓	✓	✓	✓		✓		✓				✓										✓	✓	✓	✓	
15	TRM-002 M L W	✓	✓	✓	✓		✓		✓				✓		✓					✓			✓	✓	✓	✓	
16	TRM-002M L -Fan	✓	✓	✓	✓		✓	✓	✓		✓	✓								✓		Optional	✓	✓	✓	✓	

TRM-002 Fan Coil Thermostat

Product Features:



01
Borderless Tempered Glass Panel.

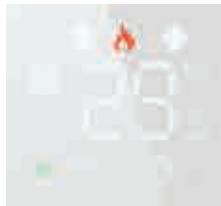

02
LED Color Display.



03
Sensitive Capacitive Touch Buttons.

Wiring Diagram:

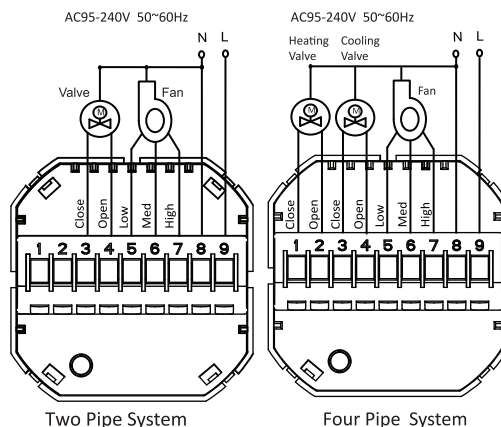

Installation Steps:

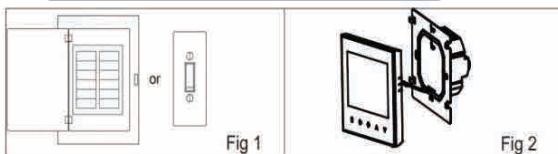

1. After correctly connecting the power supply and equipment cables to the terminals of the power supply box use a screwdriver to pass the screws through the mounting steel plate and fix them on the cassette.

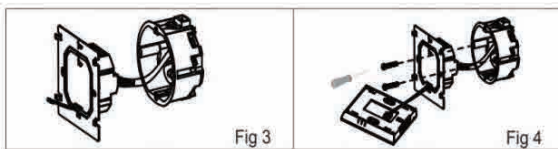

2. After the power box is fixed connect the cable to the operation panel.

3. Put the operation panel against the installation steel plate and slide it down.

4. Installation is complete.

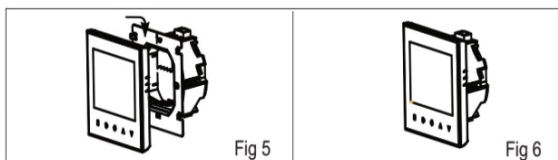

Elegance in the details

Pure black / pure white classic appearance color matching rejects old-fashioned Monotony

Tempered glass panel leaves no scratches, easy to clean.

Wall visible thickness 12mm.

Support ODM/OEM Function customization.

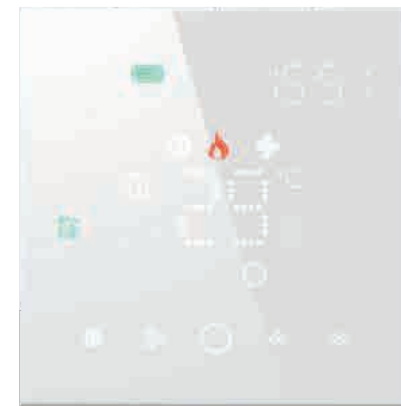
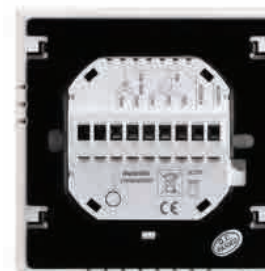



TRM-003

Fan Coil Thermostat series Selection table

No	Model	Power Supply		Control		Fan			Application						Additional						Color			
		220VAC	24VAC	Heat	Cool	1 Speed	3 Speed	0-1 0V	2-pipe	4-pipe	2 wired Motorized Valve	3 wired Motorized Valve	0-1 0V Motorized Valve	0-1 0V Damper	Modbus	WIFI	Keycard	Window	Programmable	External Sensor	Battery	White	Black	Other
1	TRM-003 A	✓	✓	✓	✓		✓		✓		✓	✓							✓		Optional	✓	✓	Pending
2	TRM-003 AN	✓	✓	✓	✓		✓		✓		✓	✓			✓							✓	✓	Pending
3	TRM-003 AW	✓	✓	✓	✓		✓		✓		✓	✓				✓			✓			✓	✓	Pending
4	TRM-003 E	✓	✓	✓	✓		✓			✓	✓	✓							✓		Optional	✓	✓	Pending
5	TRM-003 EN	✓	✓	✓	✓		✓			✓	✓	✓			✓							✓	✓	Pending
6	TRM-003 EW	✓	✓	✓	✓		✓			✓	✓	✓				✓			✓			✓	✓	Pending
7	TRM-003 M	✓	✓	✓	✓		✓		✓				✓						✓		Optional	✓	✓	Pending
8	TRM-003 M N	✓	✓	✓	✓		✓		✓				✓		✓							✓	✓	Pending
9	TRM-003 M W	✓	✓	✓	✓		✓		✓				✓			✓			✓			✓	✓	Pending

TRM-005 Fan Coil Thermostat

Product Features:



01

Black and white piano contrast color

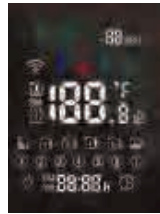

02

LED Colorful Display.



03

2.5D invisible border window

Wiring Diagram:

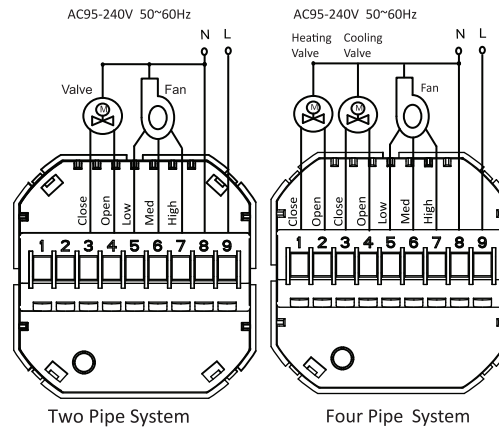

Installation Steps:

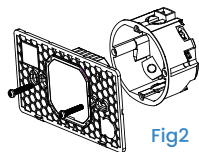
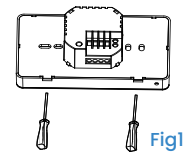

1. Use a screwdriver to pry open the mounting plate along the buckle position. After prying open, connect the cable to the screen and the power box without removing the cable.

2. Make sure that the wires are without electricity, connect the thermostat with the wires according to the wiring diagram, and then fix the mounting plate on the cassette with.

3. Snap the thermostat screen and the mounting plate together to complete the installation. Power on for testing.

4. Installation is completed.

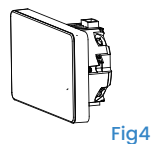
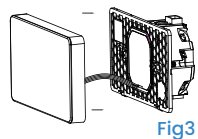

Fashion horizontal screen sliding temperature control

Feel the warmth and touch life.

Black + White acrylic panel, easy to clean, flame resistant.

Wall visible thickness 13.6mm

Cooling/heating/ventilation/energy saving.

Multi-mode selection.

Manual/automatic operation mode can be switched arbitrarily.





TRM-005

Fan Coil Thermostat series Selection table

No	Model	Power Supply		Control		Fan			Application						Additional						Color			
		220VAC	24VAC	Heat	Cool	1 Speed	3 Speed	0-1 0V	2-pipe	4-pipe	2 wired Motorized Valve	3 wired Motorized Valve	0-1 0V Motorized Valve	0-1 0V Damper	Modbus	WiFi	Keycard	Window	Programmable	External Sensor	Battery	White	Black	Other
1	TRM-005 A	✓	✓	✓	✓		✓		✓		✓	✓							✓		Optional	✓	✓	Pending
2	TRM-005 AN	✓	✓	✓	✓		✓		✓		✓	✓			✓							✓	✓	Pending
3	TRM-005 AW	✓	✓	✓	✓		✓		✓		✓	✓				✓			✓			✓	✓	Pending
4	TRM-005 E	✓	✓	✓	✓		✓			✓	✓	✓							✓		Optional	✓	✓	Pending
5	TRM-005 EN	✓	✓	✓	✓		✓			✓	✓	✓			✓							✓	✓	Pending
6	TRM-005 EW	✓	✓	✓	✓		✓			✓	✓	✓				✓			✓			✓	✓	Pending
7	TRM-005 M	✓	✓	✓	✓		✓		✓				✓						✓		Optional	✓	✓	Pending
8	TRM-005 M N	✓	✓	✓	✓		✓		✓				✓		✓							✓	✓	Pending
9	TRM-005 M W	✓	✓	✓	✓		✓		✓				✓			✓			✓			✓	✓	Pending

TRM-006 Fan Coil Thermostat

Product Features:

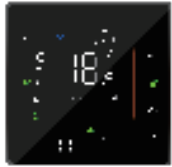

01
Borderless Rounded
Acrylic Panel.



02
LED Four-Color
Digital Display.



03
Patented Disassembly
And Installation.

Wiring Diagram:

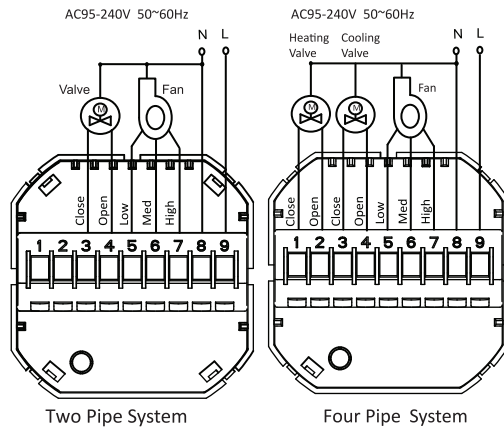

Installation Steps:

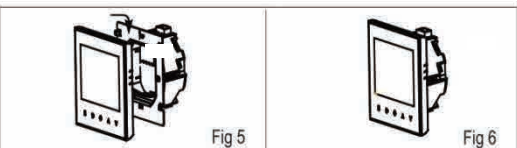
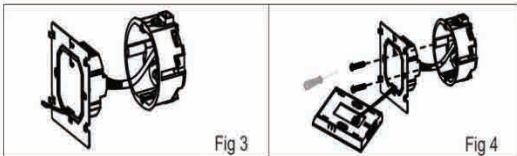
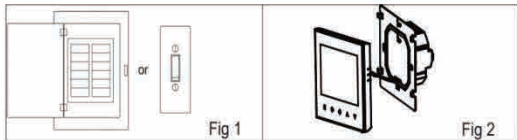

1. Keep power off.
2. Push the LCD assembly up and down to remove the mounting plate.
3. Connect power supply, load into the appropriate terminals. "See FIG3".
4. Fix the mounting plate into the wall with screws in the box.
5. Fasten body of thermostat and the mounting plate through rotating.
6. Installation is completed



Enjoy the freedom of vision

Simple White + elegant black
two-color modeling light luxury
style.

Frameless hardened Acrylic Multicolor lenses.
Thin and light with a thickness of 11.9,,
Suitable for temperature control such as central air
conditioner/fan coil unit.
Widely used for intelligent temperature control in home/office
enviroment.



■ □ (Other colors can be customized)

Smart temperature adjustment
Energy saving, environmental protection and electricity saving

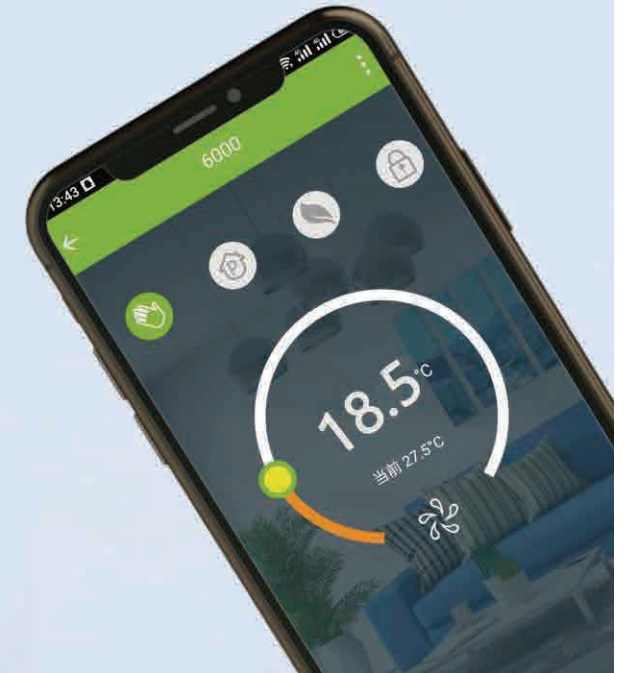

TRM-006

Fan Coil Thermostat series Selection table

No	Model	Power Supply		Control		Fan			Application					Additional						Color				
		220VAC	24VAC	Heat	Cool	1 Speed	3 Speed	0-1 0V	2-pipe	4-pipe	2 wired Motorized Valve	3 wired Motorized Valve	0-1 0V Motorized Valve	0-1 0V Damper	Modbus	WIFI	Keycard	Window	Programmable	External Sensor	Battery	White	Black	Other
1	TRM-006 AW	√	√	√	√		√		√		√	√				√			√			√	√	Pending
2	TRM-006 EW	√	√	√	√		√			√	√					√			√			√	√	Pending
3	TRM-006 M	√	√	√	√			√	√				√						√		Optional	√	√	Pending

TRM-007 Fan Coil Thermostat

Product Features:



01
Full Screen Small
Rounded Acrylics Lens.

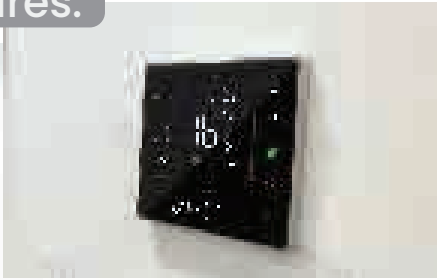

02
Engineering Quality
Super Cost-Effective.



03
Patented Disassembly
And Installation.

Wiring Diagram:

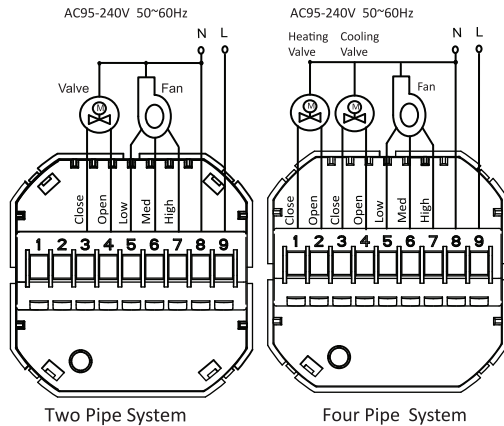

Installation Steps:

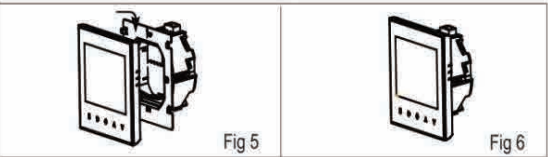
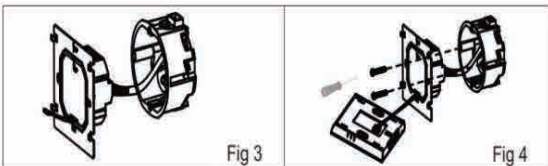
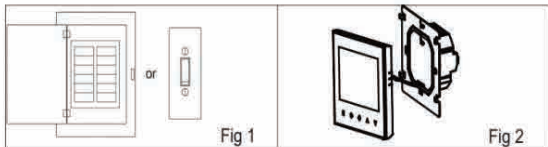

1. Keep power off.
2. Push the LCD assembly up and down to remove the mounting plate.
3. Connect power supply, load into the appropriate terminals.
4. Fix the mounting plate into the wall with screws in the box.
5. Fasten body of thermostat and the mounting plate through rotating.
6. Installation is completed.



Designed for lightweight home systems:

Bring you a high-quality temperature control experience.

Full Screen LED Multi-Color Digital Display.
Simple UI Interactive Interface.
Engineering Control Mode That Removes Unnecessary Cumbersome Functions.
Built-in Memory Storage, Even If the Power is Suddenly Turned Off,
The Set Data Will Not Be Lost.

Black White (Other colors can be customized)





TRM-007

Fan Coil Thermostat series Selection table

No	Model	Power Supply		Control		Fan			Application					Additional					Color					
		220VAC	24VAC	Heat	Cool	1 Speed	3 Speed	0-10V	2-pipe	4-pipe	2 wired Motorized Valve	3 wired Motorized Valve	0-10V Motorized Valve	0-10V Damper	Modbus	WIFI	Keycard	Window	Programmable	External Sensor	Battery	White	Black	Other
1	TRM-007 A	√	√	√	√		√		√		√	√							√		Optional	√	√	Pending
2	TRM-007 E	√	√	√	√		√			√	√								√		Optional	√	√	Pending

TRM-6001 Fan Coil Thermostat

Product Features:



01
Black + White.



02
LED No Window
Acrylic Lens.



03
Patented Disassembly
Convenient Installation.

Wiring Diagram:

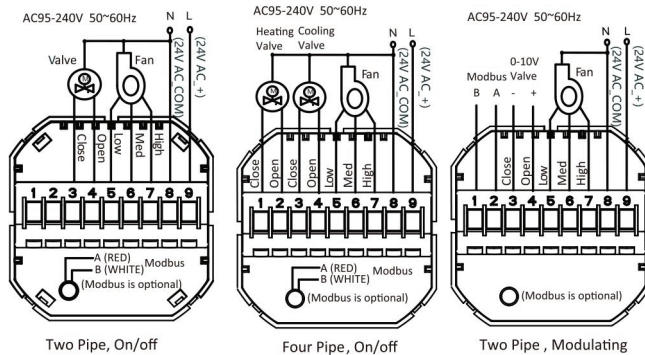

Two Pipe, On/off

Four Pipe, On/off

Two Pipe, Modulating

Installation Steps:

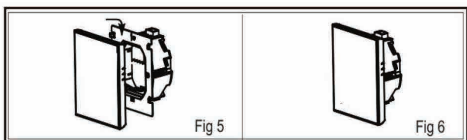
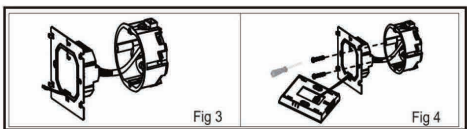
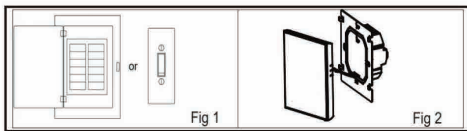

1. Keep power off
2. Remove the mounting plate by pushing the LED assembly.
3. Connect the power supply and load it into the appropriate terminals "See FIG3".
4. Securely fix the mounting plate to the wall with screws.
5. Fasten body of thermostat and the mounting plate through rotating "See FIG5".
6. Installation is completed.



BAC-008 Series Fan Coil Thermostat
**Ideal for home
temperature control**

Enjoy High Intellectual Life

The Highly Integrated Chips Brings Your a More Stable Temperature Control Experience, Wich Is The Ideal Choice For Your Home Teperature Control.



Black: White (Other colors can be customized)

TRM-008 Series Fan Coil Thermostat

Create excellent products with enduring value



TRM-008

Fan Coil Thermostat series Selection table

No	Model	Power Supply		Control		Fan			Application					Additional					Color					
		220VAC	24VAC	Heat	Cool	1 Speed	3 Speed	0-1 0V	2-pipe	4-pipe	2 wired Motorized Valve	3 wired Motorized Valve	0-1 0V Motorized Valve	0-1 0V Damper	Modbus	WIFI	Keycard	Window	Programmable	External Sensor	Battery	White	Black	Other
1	TRM-009 A	✓	✓	✓	✓		✓		✓		✓	✓							✓		Optional	✓	✓	Pending
2	TRM-009 AW	✓	✓	✓	✓		✓		✓		✓	✓			✓				✓			✓	✓	Pending
3	TRM-009 E	✓	✓	✓	✓		✓			✓	✓	✓							✓		Optional	✓	✓	Pending
4	TRM-009 EW	✓	✓	✓	✓		✓			✓	✓	✓			✓				✓			✓	✓	Pending

TRM-009 KONB FCU THERMOSTAT

Product Features:



01
Black + White.



02
Knob Color Light Effect.



03
Patent Appearance.

Wiring Diagram:

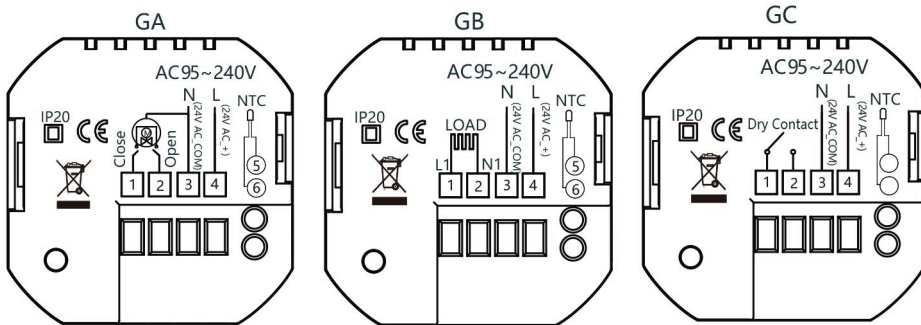

Installation Steps:

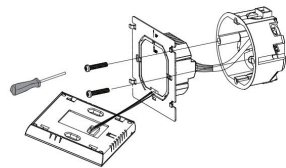
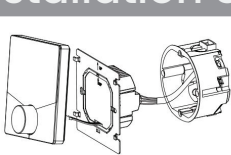

1. Turn off the main power supply before installation, and separate the installation panel by sliding the display frame. Connect the line of the back cover of the unit by referring to the wiring diagram and the picture above;

2. use screws to install the panel with 60mm European cartridges Fixed, embedded in the wall;

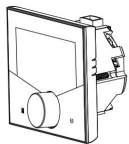

4. The installation is complete.

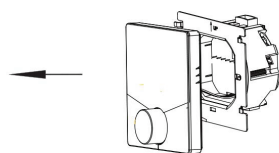

3. Install the display part back to the installation panel.



Rotary Temperature Control Lights Up The Beauty

Three-Dimensional Appearance With Dazzling Color Equivalent, Carefully Embellish Your Life



Black White (Other colors can be customized)



New! **Smart Knob Thermostat**
Retro knob temperature control with modern simple interface design
Elegant and generous with a sense of wisdom



TRM-009

Fan Coil Thermostat series Selection table

No	Model	Power Supply		Control		Fan			Application				Additional					Color						
		220VAC	24VAC	Heat	Cool	1 Speed	3 Speed	0-1 0V	2-pipe	4-pipe	2 wired Motorized Valve	3 wired Motorized Valve	0-1 0V Motorized Valve	0-1 0V Damper	Modbus	WiFi	Keycard	Window	Programmable	External Sensor	Battery	White	Black	Other
1	TRM-009 A	✓	✓	✓	✓		✓		✓		✓	✓							✓		Optional	✓	✓	Pending
3	TRM-009 AW	✓	✓	✓	✓		✓		✓		✓	✓			✓				✓			✓	✓	Pending
4	TRM-009 E	✓	✓	✓	✓		✓			✓	✓								✓		Optional	✓	✓	Pending
6	TRM-009 EW	✓	✓	✓	✓		✓			✓	✓				✓				✓			✓	✓	Pending

TRM-008 Fan Coil Thermostat

Product Features:



01
Mirror Glass Acrylic Selection



02
LCD Blue Negative Display



03
Matte Silver Border

Wiring Diagram:

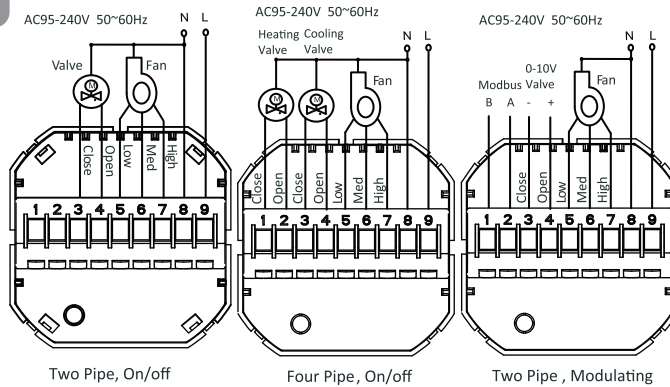

Installation Steps:

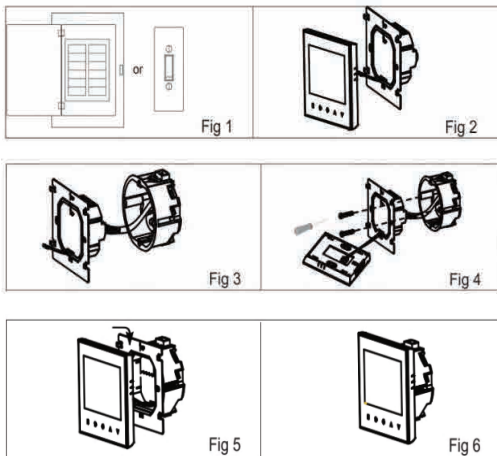

1. After correctly connecting the power supply and equipment cables to the terminals of the power supply box, use a screwdriver to pass the screws through the mounting steel plate and fix them on the cassette.
2. After the power box is fixed connect the cable to the operation panel.
3. Put the operation panel against the installation steel plate and slide it down.
4. Installation is completed.

Minimalist Look

Wisdom is extraordinary

Push-up Installation, bid farewell to the era of tools.
Flush Mount Design.

Clearly Visible Thinness That Blends into a Variety Of Home Styles.
Support ODM/OEM Function Customization.



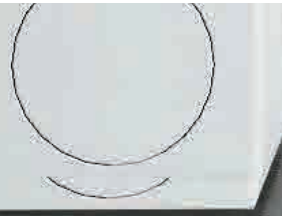

TRM-1000

Fan Coil Thermostat series selection table

No	Model	Power Supply		Control		Fan				Application				Additional							Color					Button light				
		220VAC	24VAC	Heat	Cool	1 Speed	3 Speed	0-1 0V	2-pipe	4-pipe	2 wired Motorized Valve	3 wired Motorized Valve	0-1 0V Motorized Valve	0-1 0V Damper	Modbus	WiFi	Zigbee	Keycard	Window	Programmable	External Sensor	Battery	White	Black	Pink	Gold	Silver	One	Four	
1	TRM-1000 AL	√	√	√	√		√		√		√	√								√		Optional	√	√	√	√	√	√		
2	TRM-1000 AL N	√	√	√	√		√		√		√	√			√									√	√	√	√	√		
3	TRM-1000 AL K	√	√	√	√		√		√		√	√					√			√		Optional	√	√	√	√	√			
4	TRM-1 000AL N K	√	√	√	√		√		√		√	√			√									√	√	√	√	√		
5	TRM-1 000AL N W2	√	√	√	√		√		√		√	√			√				√					√	√	√	√	√		
6	TRM-1 000AL N E	√	√	√	√		√		√		√	√			√						√			√	√	√	√	√		
7	TRM-1 000AL E	√	√	√	√		√		√		√	√								√	√	Optional	√	√	√	√	√			
8	TRM-1 000AL W	√	√	√	√		√		√		√	√				√				√			√	√	√	√	√			
9	TRM-1 000EL	√	√	√	√		√			√	√	√								√		Optional	√	√	√	√	√	√		
10	TRM-1 000EL N	√	√	√	√		√			√	√	√			√								√	√	√	√	√			
11	TRM-1 000EL N K	√	√	√	√		√			√	√	√			√			√					√	√	√	√	√			
12	TRM-1 000EL W	√	√	√	√		√			√	√	√				√				√			√	√	√	√	√			
13	TRM-1 000M L	√	√	√	√		√		√				√							√		Optional	√	√	√	√	√	√		
14	TRM-1 000M L N	√	√	√	√		√		√				√		√								√	√	√	√	√			
15	TRM-1 000EM L	√	√	√	√		√			√			√							√			√	√	√	√	√			
16	TRM-1 000EM L N	√	√	√	√		√			√			√		√								√	√	√	√	√			
17	TRM-1 000M L K	√	√	√	√		√		√				√					√					√	√	√	√	√			
18	TRM-1 000M L W	√	√	√	√		√		√				√				√						√	√	√	√	√			
19	TRM-1 000M L -Fan	√	√	√	√			√	√		√	√								√		Optional	√	√	√	√	√	√		
20	TRM-1 000DL	√	√		√								√							√		Optional	√	√	√	√	√			
21	TRM-1 000DL N	√	√		√								√	√									√	√	√	√	√			
22	TRM-1 000DX1	√		√			√			1 Stage											√		√	√	√	√	√			
23	TRM-1 000DX2		√	√		√				2Stage											√		√	√	√	√	√			
24	TRM-1 000DX3	√		√			√			2Stage					√								√	√	√	√	√			
25	TRM-1 000DX4	√		√		√				2Stage					√								√	√	√	√	√			
26	TRM-1 000DX5		√	√		√				2Stage					√								√	√	√	√	√			
27	TRM-1 000DX6		√	√		√				2Stage					√								√	√	√	√	√			
28	TRM-1 000DX1 W	√		√			√			1 Stage										√			√	√	√	√	√			

TRM-2000 Fan Coil Thermostat

Product Features:



01
Mirror Glass Acrylic Selection.



02
Simple Operation Interface.



03
Luxury Piano Brushed Top.

Wiring Diagram:

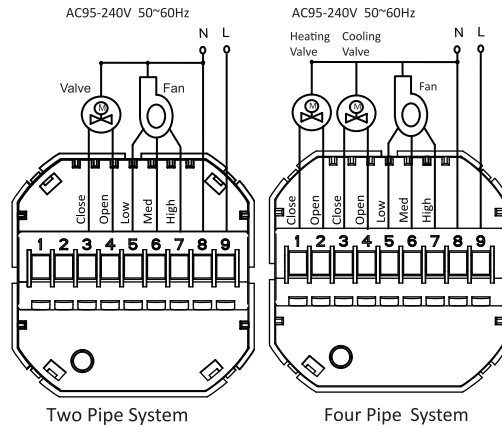

Installation Steps:

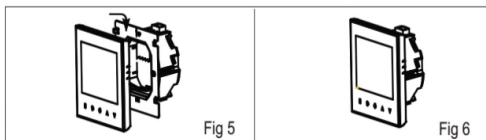
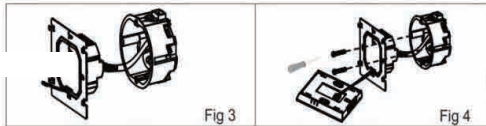
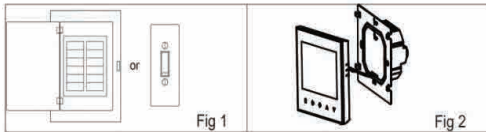

1. After correctly connecting the power supply and equipment cables to the terminals of the power supply box, use a screwdriver to pass the screws through the mounting steel plate and fix them on the cassette.
2. After the power box is fixed, connect the cable to the operation panel.
3. Put the operation panel against the installation steel plate and slide it down.
4. Installation is completed.



Enjoy Smart Life Easily

Matte Silver Border.
Flush Mount Design.
Clearly Visible Thinness That Blends Into a Variety Of Home Styles
Support ODM/OEM Function Customization.

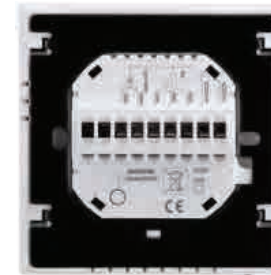

Black White Silver Pink Gold (Other colors can be customized)

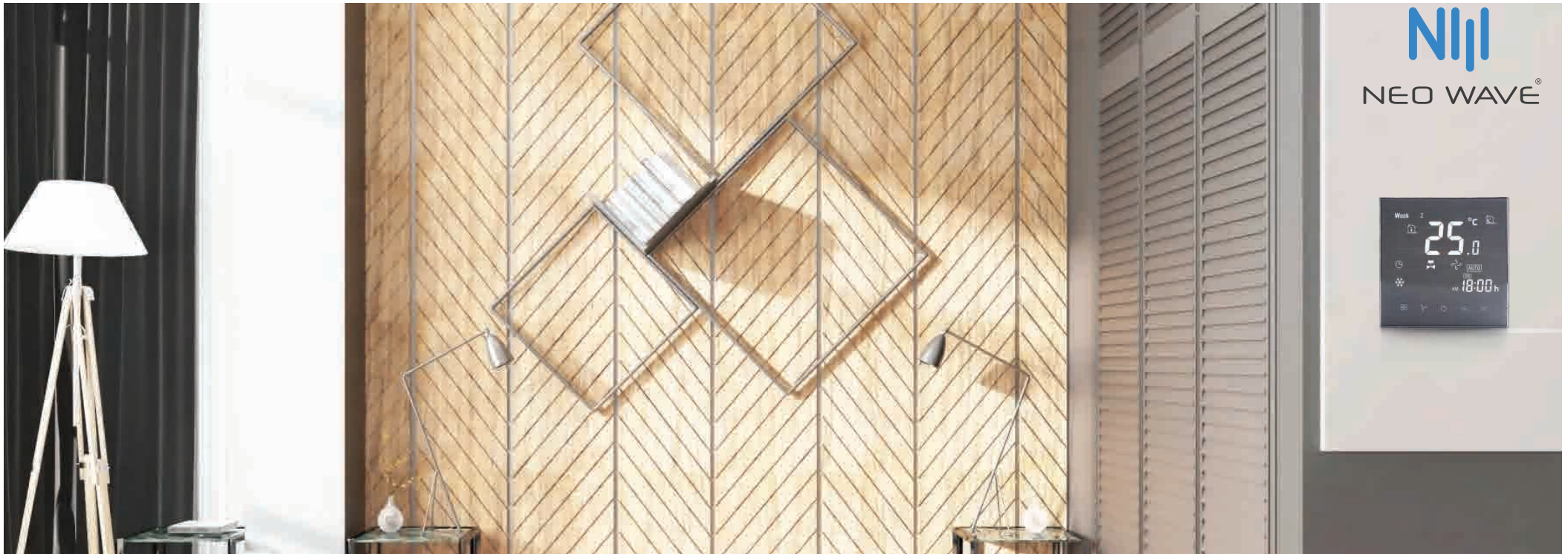

TRM-2000

Fan Coil Thermostat series Selection table

No	Model	Power Supply		Control		Fan			Application					Additional						Color				Button light				
		220VAC	24VAC	Heat	Cool	1 Speed	3 Speed	0-1 0V	2-pipe	4-pipe	2 wired Motorized Valve	3 wired Motorized Valve	0-1 0V Motorized Valve	0-1 0V Damper	Modbus	WIFI	Zigbee	Keycard	Window	Programmable	External Sensor	Battery	White	Black	Pink	Brushed SS	One	Four
1	TRM-2000 AL	✓	✓	✓	✓		✓			✓	✓											Optional	✓	✓	✓	✓	✓	
2	TRM-2000 AL N	✓	✓	✓	✓		✓			✓	✓			✓									✓	✓	✓	✓		
3	TRM-2000 AL K	✓	✓	✓	✓		✓			✓	✓						✓		✓			Optional	✓	✓	✓	✓		
4	TRM-2000AL N K	✓	✓	✓	✓		✓			✓	✓			✓			✓						✓	✓	✓	✓		
5	TRM-2000AL W	✓	✓	✓	✓		✓			✓	✓				✓				✓				✓	✓	✓	✓		
6	TRM-2000AL ZB	✓	✓	✓	✓		✓			✓	✓					✓			✓				✓	✓	✓	✓		
7	TRM-2000EL	✓	✓	✓	✓		✓		✓	✓	✓								✓			Optional					✓	
8	TRM-2000EL N	✓	✓	✓	✓		✓		✓	✓	✓			✓									✓	✓	✓	✓		
9	TRM-2000EL W	✓	✓	✓	✓		✓		✓	✓	✓				✓				✓				✓	✓	✓	✓		
10	TRM-2000EL ZB	✓	✓	✓	✓		✓		✓	✓	✓					✓			✓				✓	✓	✓	✓		
11	TRM-2000M L	✓	✓	✓	✓		✓					✓							✓			Optional	✓	✓	✓	✓	✓	
12	TRM-2000M L N	✓	✓	✓	✓		✓					✓		✓									✓	✓	✓	✓		
13	TRM-2000M L K	✓	✓	✓	✓		✓					✓					✓		✓				✓	✓	✓	✓		
14	TRM-2000M L NK	✓	✓	✓	✓		✓		✓			✓		✓				✓					✓	✓	✓	✓		

TRM-3000 Fan Coil Thermostat

Product Features:



01
3.2-inch Large Negative Screen.



02
Adjustable Backlight Brightness.

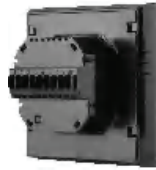

03
Push-Up Convenient Installation.

Wiring Diagram:

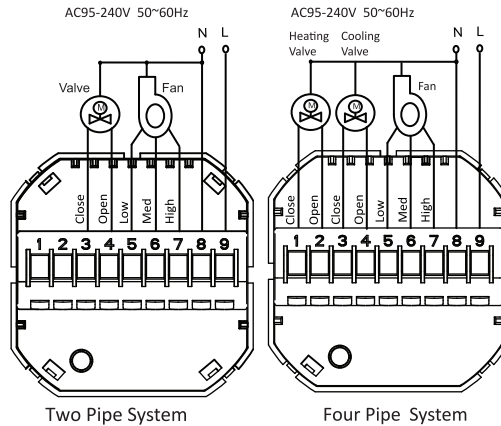

Two Pipe System

Four Pipe System

Installation Steps:

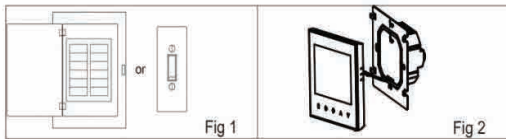

Fig 1

Fig 2

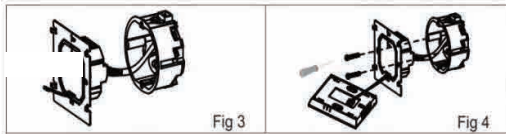

Fig 3

Fig 4

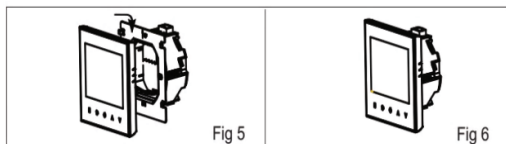

Fig 5

Fig 6

1. After correctly connecting the power supply and equipment cables to the terminals of the power supply box, use a screwdriver to pass the screws through the mounting steel plate and fix them on the cassette.
2. After the power box is fixed, connect the cable to the operation panel.
3. Put the operation panel against the installation steel plate and slide it down.
4. Installation is completed.



Meet the best you

White, Black, Piano Brushed Three Appearances.

White, Blue, Orange Three-Color Negative Display Large Screen. High-End Color Matching Is Suitable For Hotel, Indoor, Office And Other Scenes.

Clearly Visible Thinness That Blends Into a variety Of Home Styles. Support ODM/OEM Advanced Function Customization.

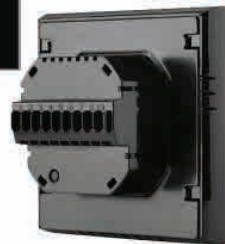



TRM-3000

Fan Coil Thermostat series Selection table

No	Model	Power Supply		Control		Fan				Application				Additional						Color				Button light				
		220VAC	24VAC	Heat	Cool	1 Speed	3 Speed	0-1 0V	2-pipe	4-pipe	2 wired Motorized Valve	3 wired Motorized Valve	0-1 0V Motorized Valve	0-1 0V Damper	Modbus	WIFI	Zigbee	Keycard	Window	Programmable	External Sensor	Battery	White	Black	Pink	Brushed SS	One	Four
1	TRM-3000 AL	✓	✓	✓	✓		✓			✓	✓											Optional	✓	✓	✓	✓	✓	
2	TRM-3000 AL N	✓	✓	✓	✓		✓			✓	✓			✓									✓	✓	✓	✓		
3	TRM-3000 AL K	✓	✓	✓	✓		✓			✓	✓						✓			✓		Optional	✓	✓	✓	✓		
4	TRM-3000AL W	✓	✓	✓	✓		✓			✓	✓				✓					✓			✓	✓	✓	✓		
5	TRM-3000AL ZB	✓	✓	✓	✓		✓			✓	✓					✓				✓			✓	✓	✓	✓		
6	TRM-3000EL	✓	✓	✓	✓		✓		✓	✓	✓									✓		Optional					✓	
7	TRM-3000EL N	✓	✓	✓	✓		✓		✓	✓	✓			✓									✓	✓	✓	✓		
8	TRM-3000EL W	✓	✓	✓	✓		✓		✓	✓	✓				✓					✓			✓	✓	✓	✓		
9	TRM-3000EL ZB	✓	✓	✓	✓		✓		✓	✓	✓					✓				✓			✓	✓	✓	✓		
10	TRM-3000M L	✓	✓	✓	✓		✓		✓			✓								✓		Optional	✓	✓	✓	✓	✓	

TRM-6000 Fan Coil Thermostat

Product Features:



01
51mm Large Negative Screen.



02
Adjustable Backlight Brightness.



03
Silver Matte Border
High-End Sense.

Wiring Diagram:

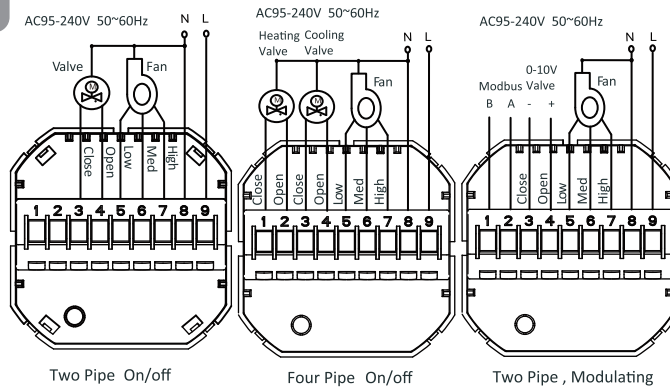

Installation Steps:

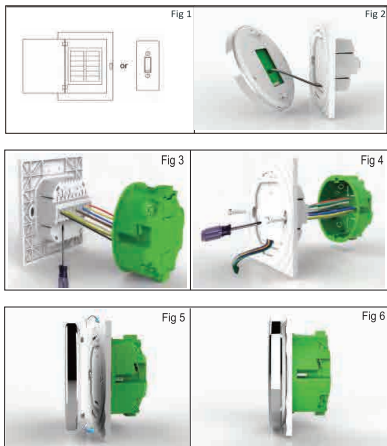

1. Turn off the main power supply.
2. After connecting the power supply and equipment cables to the terminals of the power supply box correctly, use a screwdriver to the screws are fixed to the cassette through the mounting steel plate.
3. After the power box is fixed, connect the cable to the operation panel.
4. Fix the installation panel with the 60mm European-Style Cassette with screws, and embed them into the wall.
5. Hold the operation panel against the mounting steel plate and slide it down.
6. The installation is completed.



His Wisdom Is Extraordinary

Simple. High Sense

- Circular Curve Design.
- Ring Function Key Layout.
- Rotary Round Square Mounting Plate.
- Support ODM/OEM Advanced Function Customization.





TRM-6000

Fan Coil Thermostat series Selection table

No	Model	Power Supply		Control		Fan			Application					Additional					Color								
		220VAC	24VAC	Heat	Cool	1 Speed	3 Speed	0-1 0V	2-pipe	4-pipe	2 wired Motorized Valve	3 wired Motorized Valve	0-1 0V Motorized Valve	0-1 0V Damper	Modbus	WIFI	Zigbee	Keycard	Window	Programmable	External Sensor	Battery	White	Black	Pink	Brushed SS	Gold
1	TRM-6000 AL	✓	✓	✓	✓		✓		✓		✓	✓								✓		Optional	✓	✓	✓	✓	✓
2	TRM-6000 AL N	✓	✓	✓	✓		✓		✓		✓	✓			✓								✓	✓	✓	✓	✓
3	TRM-6000 AL K	✓	✓	✓	✓		✓		✓		✓	✓						✓				Optional	✓	✓	✓	✓	✓
4	TRM-6000AL N K	✓	✓	✓	✓		✓		✓		✓	✓			✓			✓					✓	✓	✓	✓	✓
5	TRM-6000AL W	✓	✓	✓	✓		✓		✓		✓	✓				✓							✓	✓	✓	✓	✓
6	TRM-6000AL ZB	✓	✓	✓	✓		✓		✓		✓	✓					✓						✓	✓	✓	✓	✓
7	TRM-6000AL NW	✓	✓	✓	✓		✓		✓		✓	✓			✓	✓							✓	✓	✓	✓	✓
8	TRM-6000EL	✓	✓	✓	✓		✓			✓	✓	✓										Optional	✓	✓	✓	✓	✓
9	TRM-6000EL N	✓	✓	✓	✓		✓			✓	✓	✓			✓								✓	✓	✓	✓	✓
10	TRM-6000EL W	✓	✓	✓	✓		✓			✓	✓	✓				✓							✓	✓	✓	✓	✓
11	TRM-6000EL ZB	✓	✓	✓	✓		✓			✓	✓	✓					✓						✓	✓	✓	✓	✓
12	TRM-6000EL NW	✓	✓	✓	✓		✓			✓	✓	✓			✓	✓							✓	✓	✓	✓	✓
13	TRM-6000M L	✓	✓	✓	✓		✓		✓				✓									Optional	✓	✓	✓	✓	✓
14	TRM-6000M L N	✓	✓	✓	✓		✓		✓				✓		✓								✓	✓	✓	✓	✓
15	TRM-6000M L K	✓	✓	✓	✓		✓		✓				✓					✓					✓	✓	✓	✓	✓
16	TRM-6000M L NK	✓	✓	✓	✓		✓		✓				✓		✓			✓					✓	✓	✓	✓	✓
17	TRM-6000M L -Fan	✓	✓	✓	✓			✓	✓				✓										✓	✓	✓	✓	✓

TRM-6001 Fan Coil Thermostat

Product Features:



01
Black + White.



02
7+1 Dynamic
Lighting Modes.



03
Round/Square
Mounting Plate.

Wiring Diagram:

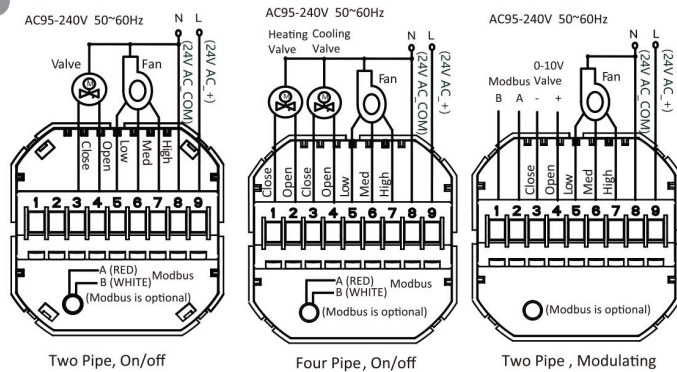

Exclusive to your temperature-controlled butler

Bring you a professional, safe and efficient indoor temperature control experience

Installation Steps:

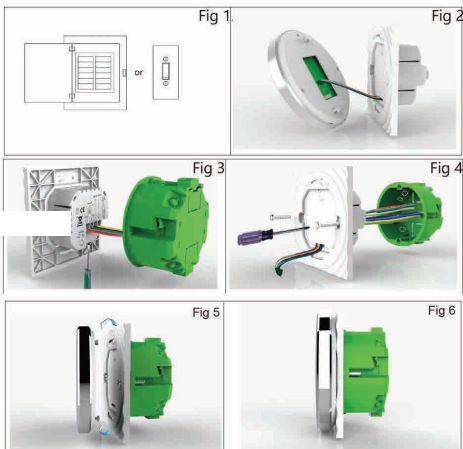

1. Keep power off
2. Remove the mounting plate.
3. Connect the power supply and load it into the appropriate terminals "See FIG3".
4. Securely fix the mounting plate to the wall with screws.
5. Fasten body of thermostat and the mounting plate through rotating "See FIG5".
6. Installation is completed.

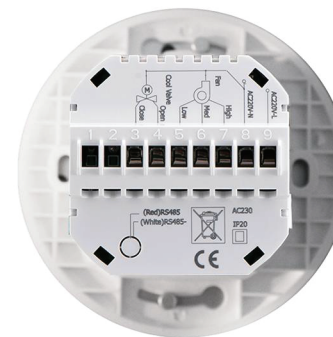

Black White (Other colors can be customized)

FCU THERMOSTAT

RAINBOW RING LIGHT EFFECT

Round large size boutique / 8 light response options
Highlighter LED lenses / Black/White classic styling



TRM-6001

Fan Coil Thermostat series Selection table

No	Model	Power Supply		Control		Fan			Application					Additional					Color					
		220VAC	24VAC	Heat	Cool	1 Speed	3 Speed	0-1 0V	2-pipe	4-pipe	2 wired Motorized Valve	3 wired Motorized Valve	0-1 0V Motorized Valve	0-1 0V Damper	Modbus	WIFI	Keycard	Window	Programmable	External Sensor	Battery	White	Black	Other
1	TRM-6001 A	✓	✓	✓	✓		✓		✓		✓	✓							✓		Optional	✓	✓	Pending
2	TRM-6001AW	✓	✓	✓	✓		✓		✓		✓	✓				✓			✓			✓	✓	Pending
3	TRM-6001E	✓	✓	✓	✓		✓			✓	✓	✓							✓		Optional	✓	✓	Pending
4	TRM-6001EW	✓	✓	✓	✓		✓			✓	✓	✓				✓			✓			✓	✓	Pending

TRM-7000 SMART KNOB THERMOSTAT

Product Features:



Variety brushed back panel options

Seven colors ambient light

Patent appearance

01
3.2-inch Large Negative Screen.

02
Adjustable Blacklight Brightness.

03
Push-Up Convenient Installation.

Wiring Diagram:

Please check the information laser printed on the TRMk of the Thermostat for the actual voltage.

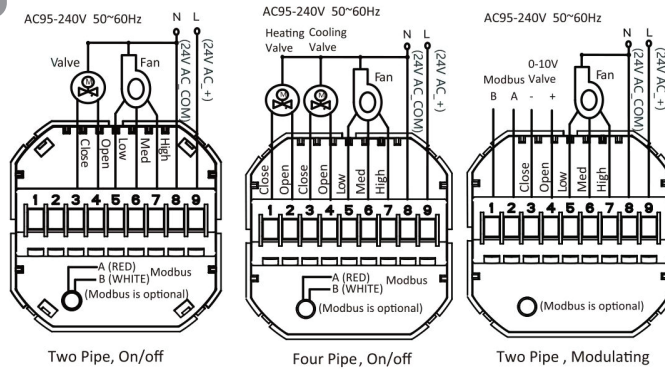

Two Pipe, On/off

Four Pipe, On/off

Two Pipe, Modulating

Installation Steps:

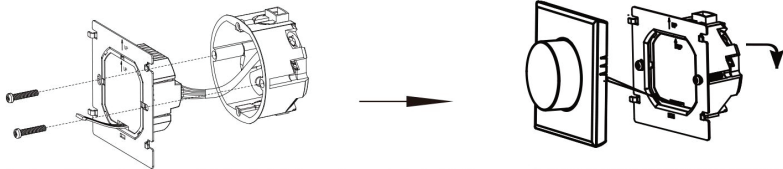

1, Turn off the main power supply before installation, and separate the installation panel by sliding the display frame. Connect the line of the back cover of the product referring to the wiring diagram and the picture above;

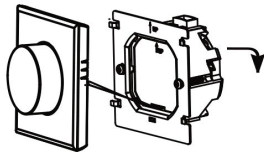

2, use screws to install the panel with 60mm European cartridges fixed, embedded in the wall;

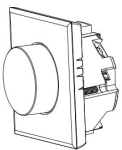

4. The installation is complete.

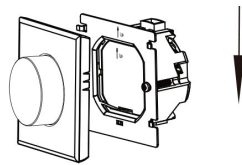

3. Install the display part back to the installation panel;

240*240 LCD screen, it is "really" very beautiful



Colorful Stereo Knob With TFT True Color Screen

The Eight Main Control Options Are Directly Set By Twisting Side Knobs Widely Used In Different Regional Scenes.



Gold SS Brushed SS Black SS
Other colors can be customized



Clever knob— Taste highly **INTELLIGENT** life

TRM-7000

Fan Coil Thermostat series Selection table

No	Model	Power Supply		Control		Fan			Application					Additional						Color					
		220VAC	24VAC	Heat	Cool	1 Speed	3 Speed	0-1 0V	2-pipe	4-pipe	2 wired Motorized Valve	3 wired Motorized Valve	0-1 0V Motorized Valve	0-1 0V Damper	Modbus	WIFI	Zigbee	Keycard	Window	Programmable	External Sensor	Battery	White	Black	Other
1	TRM-7000ALW	√	√	√	√		√		√		√	√			√					√			√	√	√
2	TRM-7000ELW	√	√	√	√		√			√	√				√					√			√	√	√

TRM-008 Fan Coil Thermostat

Product Features:



01

4.8-inch Multi-Color Large Screen Display

02

15mm Ultra-Thin Visible Wall Thickness

03

Silver Metal Frame

Wiring Diagram:

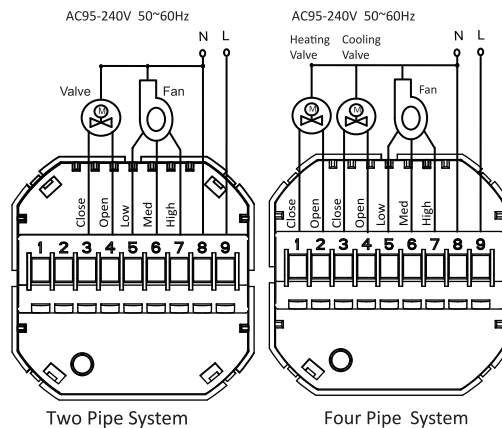

Installation Steps:

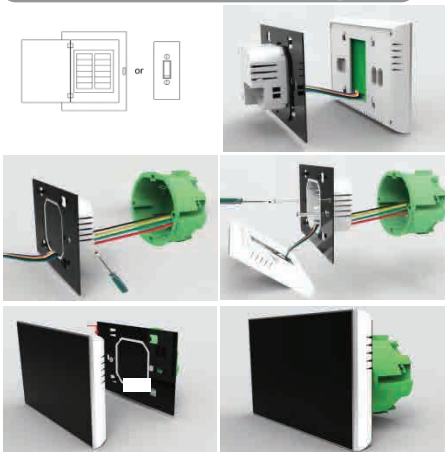

1. As shown in fig1, Turn off the main power supply.
2. As Shown in fig2, By twisting the frame of the display screen, unscrew the installation panel.
3. Refer to the wiring diagram and fig3 and connect the TRMk cover circuit of the product.
4. As shown in fig4 fix the installation panel to the 60mm European-Style Cassette with screws, and embed into the wall.
5. As shown in fig5 rotate the display part TRMK to the installation panel.
6. As shown in fig6 the installation is completed.



Smart Aesthetics

Warm with heat, Smart and energy-saving

The Center Color-Changing ring is more techological.

6 Touch function keys design.

Wall and flush mount compatible.

7 Days and 4 periods of programming/temporary manual Programming/manual mode/holiday mode free transfer.

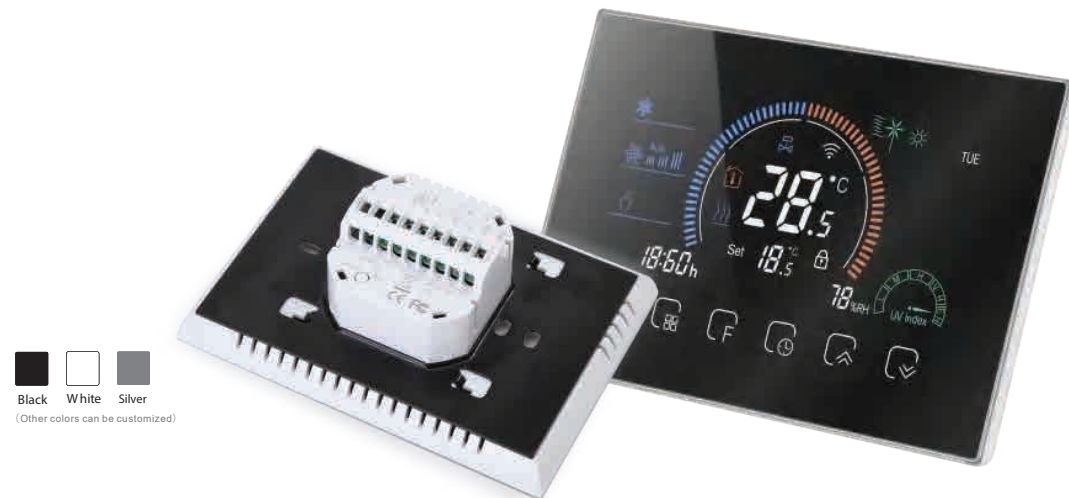



TRM-8000

Fan Coil Thermostat series selection table

No	Model	Control		Fan			Application					Additional					Color					
		Heat	Cool	1 Speed	3 Speed	0-1 0V	2-pipe	4-pipe	2 wired Motorized Valve	3 wired Motorized Valve	0-1 0V Motorized Valve	0-1 0V Damper	Modbus	WIFI	Keycard	Window	Programmable	External Sensor	Battery	White	Black	Brushed SS
1	TRM-8000 AL	✓	✓		✓		✓		✓	✓						✓		✓	✓	✓	✓	✓
2	TRM-8000AL W	✓	✓		✓		✓		✓	✓				✓		✓			✓	✓	✓	✓
3	TRM-8000EL	✓	✓		✓			✓	✓	✓						✓		✓	✓	✓	✓	✓
4	TRM-8000EL W	✓	✓		✓			✓	✓	✓				✓		✓			✓	✓	✓	✓
5	TRM-8000M L	✓	✓		✓		✓				✓					✓		✓	✓	✓	✓	✓
6	TRM-8000M L W	✓	✓		✓		✓				✓			✓		✓			✓	✓	✓	✓