

Overview :

The NEOWAVE TxTH28 temperature and humidity transducer is specifically crafted for indoor temperature and humidity detection, offering a compact size, straightforward installation, and ease of use. Engineered with specialized designs for lightning surge, electrostatic discharge, group pulse, withstand voltage, it boasts robust anti-interference capabilities. With current, voltage, and RS485 output modes, it finds versatile applications in computer rooms, buildings, warehouses, and other environments requiring temperature and humidity measurements.

Dimensions :

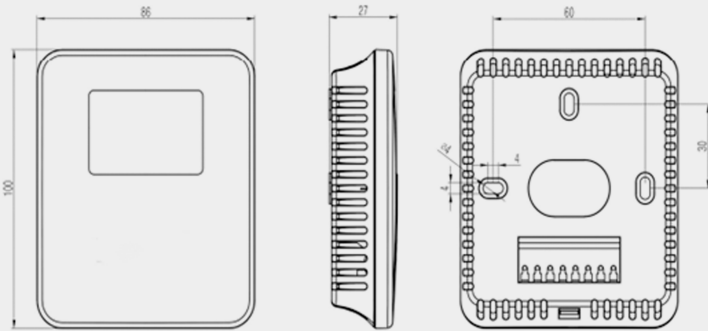

Application :

1. Computer rooms
2. HVAC systems
3. Buildings and structures
4. Warehouses and storage spaces
5. Various environments requiring temperature and humidity measurement and control

Feature :

- ▮ Fits standard 86 box installation.
- ▮ Light, beautiful shell design.
- ▮ LCD backlight dual display.
- ▮ Imported high-precision sensors and control.
- ▮ Optional passive temperature output.
- ▮ CE and RoHS certified.

TxTH28 :



Application :

1. Open the transducer by pressing the button beneath the back cover (refer to Figures 1 and 2).
2. Follow the wiring diagram for electrical connections, guiding the cable through the designated hole (as illustrated in Figure 4).
3. Use the three mounting holes on the back cover to secure the transducer to the wall using expansion screws (Figure 5) or to pre-embedded 86 boxes on the wall (Figure 6).
4. Align and secure the front cover to the bottom case, completing the installation process (Figure 7).

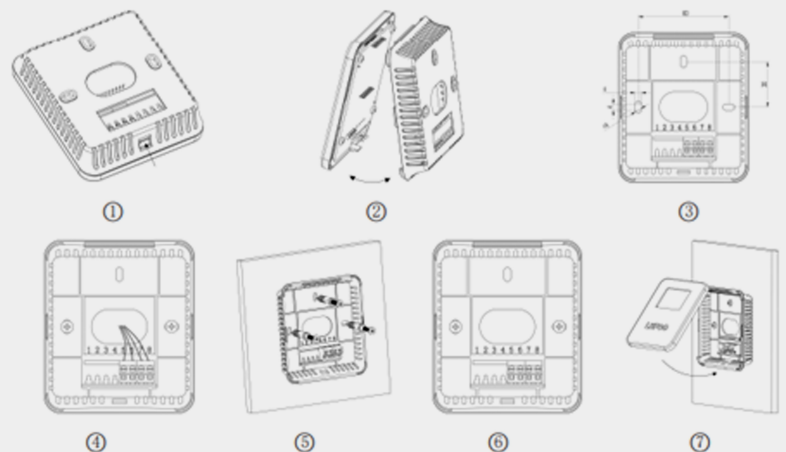



NEOWAVE®

NEOWAVE Indoor Temperature and Humidity Transducer TxTH28

Specification :

Relative Humidity

Sensor	Digital type
Range	0%~100%RH
Output	RS485/Modbus,0~10VDC, 4~20mA optional
Accuracy	±3%@ 20 & 20~80%RH
Response time	≤10s(25 , slow flow air)

Temperature

Sensor	Digital or RTD, refer to selection table
Range	0~50 , -20~60 , etc
Output Signal	4~20mA,0~10VDC, RS485/Modbus optional
RTD(thermal resistor)	Refer to the selection table and RTD indexing table
Accuracy	Digital sensor: ±0.3 @20 ; RTD: Typical ±0.2~0.4 @25 , refer to selection table
Power Supply	Voltage type/485 type 15~35VDC/24VAC±20% ; Current type 19.5~35VDC (RL=500Ω)/9.5~35VDC (RL=0Ω)
Output Load	≤500Ω(current type), ≥2KΩ(voltage type)
Display	Optional LCD display with unit display and backlight (4~20mA without backlight)
Shell Material	PC
Working Environment	-20~60 , 5%-95%RH(non-condensing)
Protection Class	IP65

Selection code :

Code and Instruction

Remark

TxTH28	Indoor Temperature Humidity Sensor		Model
3	±3%RH(±0.3c)		Accuracy
A	4~20mA(Two-wired)		Humidity output
V10	0~10VDC(Three-wired)		
RS	RS485/Modbus		
N	No output		
A	4~20mA(Two-wired)		Temperature output
V10	0~10VDC(Three-wired)		
RS	RS485/Modbus		
1	PT1000C±0.2C@0C		
2	PT100C±0.2C@0C		
3	NTC20KC±0.4C@25C		
5	NTC10K,±0.4C@25C		
N	No output		
0	Non		Range
1	0~50C		
2	-20~60		
9	Customizable		
1	Without displa		Display
2	LCD digital display		